

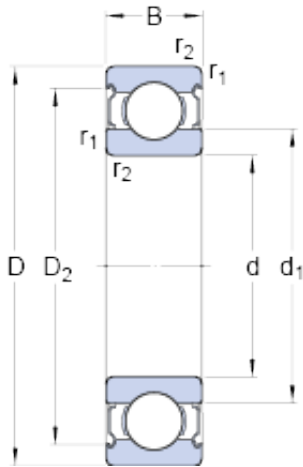

## Shandong Bohong Bearing Co., Ltd.



6020-2z Bearing 2D drawings and 3D CAD models

### NSK SKF 6020-2z Deep Groove Ball Bearing 6020-Z Bearings Size: 100X150X24 mm

Bearing No. 6020-2z

Size	150x100x24 mm
Bore Diameter	150 mm
Outer Diameter	100 mm
Width	24 mm
d	100 mm
D	150 mm
B	24 mm
d <sub>1</sub>	115,95 mm
D <sub>2</sub>	138,3 mm
r <sub>1,2</sub> - min.	1,5 mm
d <sub>a</sub> - min.	107 mm
d <sub>a</sub> - max.	115,9 mm
D <sub>a</sub> - max.	143 mm
r <sub>a</sub> - max.	1,5 mm
Basic dynamic load rating - C	63,7 kN
Basic static load rating - C <sub>0</sub>	54 kN
Fatigue load limit - P <sub>u</sub>	2 kN
Reference speed	9500 r/min
Limiting speed	4500 r/min
Calculation factor - k <sub>r</sub>	0,025
Calculation factor - f <sub>0</sub>	15,9
Category	Single Row Ball Bearings
Inventory	0.0
Manufacturer Name	SKF



## Shandong Bohong Bearing Co., Ltd.

Minimum Buy Quantity	N/A
Weight / Kilogram	1.34
EAN	7316576624667
Product Group	B00308
Enclosure	2 Metal Shields
Precision Class	ABEC 1   ISO P0
Maximum Capacity / Filling Slot	No
Rolling Element	Ball Bearing
Snap Ring	No
Internal Special Features	No
Cage Material	Steel
Internal Clearance	C0-Medium
Inch - Metric	Metric
Long Description	100MM Bore; 150MM Outside Diameter; 24MM Outer Race Diameter; 2 Metal Shields; Ball Bearing; ABEC 1   ISO P0; No Filling Slot; No Snap Ring; No Internal Special Features
Category	Single Row Ball Bearing
UNSPSC	31171504
Harmonized Tariff Code	8482.10.50.68
Noun	Bearing
Keyword String	Ball
Manufacturer URL	<a href="http://www.skf.com">http://www.skf.com</a>
Manufacturer Item Number	6020-2Z
Weight / LBS	2.95
Outer Race Width	0.945 Inch   24 Millimeter
Outside Diameter	5.906 Inch   150 Millimeter
Bore	3.937 Inch   100 Millimeter
bore diameter:	100 mm
static load capacity:	54 kN



## Shandong Bohong Bearing Co., Ltd.

outside diameter:	150 mm
precision rating:	Not Rated
overall width:	24 mm
finish/coating:	Uncoated
bore type:	Round
cage material:	Steel
closure type:	Double Shielded
outer ring width:	24 mm
row type & fill slot:	Single Row Non-Fill Slot
fillet radius:	1.5 mm
internal clearance:	C0
maximum rpm:	4500 RPM
dynamic load capacity:	63.7 kN
series:	60
$d_1$	115.95 mm
$D_2$	138.3 mm
$r_{1,2}$ min.	1.5 mm
$d_a$ min.	107 mm
$d_a$ max.	115.9 mm
$D_a$ max.	143 mm
$r_a$ max.	1.5 mm
Basic dynamic load rating C	63.7 kN
Basic static load rating $C_0$	54 kN
Fatigue load limit $P_u$	2.04 kN
Calculation factor $k_r$	0.025
Calculation factor $f_0$	15.9
Mass bearing	1.32 kg