

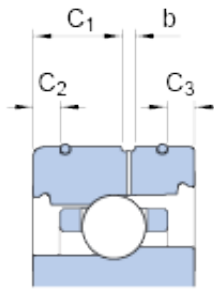

# Shandong Bohong Bearing Co., Ltd.

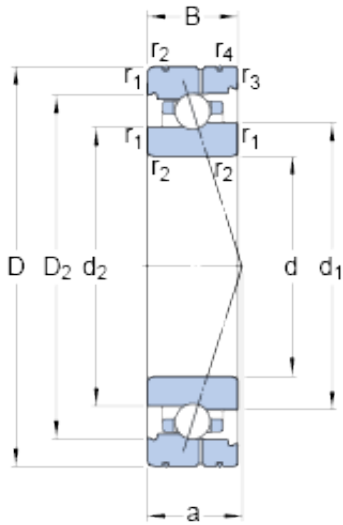

## 85 mm x 130 mm x 22 mm SKF 7017 ACB/HCP4AL angular contact ball bearings

Bearing No. 7017 ACB/HCP4AL

7017 ACB/HCP4AL Bearing 2D drawings and 3D CAD models

Size	130x85x22 mm
Bore Diameter	130 mm
Outer Diameter	85 mm
Width	22 mm
d	85 mm
D	130 mm
B	22 mm
d <sub>1</sub>	101.7 mm
d <sub>2</sub>	99.3 mm
D <sub>2</sub>	116.4 mm
b	2.5 mm
C <sub>1</sub>	11.1 mm
C <sub>2</sub>	4.7 mm
C <sub>3</sub>	3.2 mm
r <sub>1,2</sub> - min.	1.1 mm
r <sub>3,4</sub> - min.	0.6 mm
a	36.3 mm
d <sub>a</sub> - min.	91 mm
d <sub>b</sub> - min.	91 mm
D <sub>a</sub> - max.	124 mm
D <sub>b</sub> - max.	126.8 mm
r <sub>a</sub> - max.	1 mm
r <sub>b</sub> - max.	0.6 mm
d <sub>n</sub>	103 mm



## Shandong Bohong Bearing Co., Ltd.

Basic dynamic load rating - C	25.1 kN
Basic static load rating - $C_0$	22.4 kN
Fatigue load limit - $P_u$	0.915 kN
Limiting speed for grease lubrication	14000 r/min
Limiting speed for oil lubrication	22000 mm/min
Ball - $D_w$	9.525 mm
Ball - z	28
$G_{ref}$	11.02 cm <sup>3</sup>
Calculation factor - e	0.68
Calculation factor - $Y_2$	0.87
Calculation factor - $Y_0$	0.38
Calculation factor - $X_2$	0.41
Calculation factor - $Y_1$	0.92
Calculation factor - $Y_2$	1.41
Calculation factor - $Y_0$	0.76
Calculation factor - $X_2$	0.67
Preload class A - $G_A$	150 N
Preload class B - $G_B$	300 N
Preload class C - $G_C$	900 N
Calculation factor - f	1.08
Calculation factor - $f_1$	0.99
Calculation factor - $f_{2A}$	1
Calculation factor - $f_{2B}$	1.02
Calculation factor - $f_{2C}$	1.05
Calculation factor - $f_{HC}$	1.01
Preload class A	163 N/micron
Preload class B	211 N/micron



## Shandong Bohong Bearing Co., Ltd.

Preload class C	316 N/micron
$d_1$	101.7 mm
$d_2$	99.3 mm
$D_2$	116.4 mm
$C_1$	11.1 mm
$C_2$	4.7 mm
$C_3$	3.2 mm
$r_{1,2}$ min.	1.1 mm
$r_{3,4}$ min.	0.6 mm
$d_a$ min.	91 mm
$d_b$ min.	91 mm
$D_a$ max.	124 mm
$D_b$ max.	126.8 mm
$r_a$ max.	1 mm
$r_b$ max.	0.6 mm
$d_n$	103 mm
Basic dynamic load rating C	30.2 kN
Basic static load rating $C_0$	33.5 kN
Fatigue load limit $P_u$	0.915 kN
Attainable speed for grease lubrication	14000 r/min
Attainable speed for oil-air lubrication	22000 r/min
Ball diameter $D_w$	9.525 mm
Number of balls z	28
Reference grease quantity $G_{ref}$	11.02 cm <sup>3</sup>
Preload class A $G_A$	150 N
Static axial stiffness, preload class A	163 N/ $\mu$ m
Preload class B $G_B$	300 N
Static axial stiffness, preload class B	211 N/ $\mu$ m
Preload class C $G_C$	900 N



## Shandong Bohong Bearing Co., Ltd.

Static axial stiffness, preload class C	316 N/ $\mu$ m
Calculation factor f	1.08
Calculation factor $f_1$	0.99
Calculation factor $f_{2A}$	1
Calculation factor $f_{2B}$	1.02
Calculation factor $f_{2C}$	1.05
Calculation factor $f_{HC}$	1.01
Calculation factor e	0.68
Calculation factor (single, tandem) $Y_2$	0.87
Calculation factor (single, tandem) $Y_0$	0.38
Calculation factor (single, tandem) $X_2$	0.41
Calculation factor (back-to-back, face-to-face) $Y_1$	0.92
Calculation factor (back-to-back, face-to-face) $Y_2$	1.41
Calculation factor (back-to-back, face-to-face) $Y_0$	0.76
Calculation factor (back-to-back, face-to-face) $X_2$	0.67
Mass bearing	0.9 kg